

KERA.BASE  
JUNCTION 45°

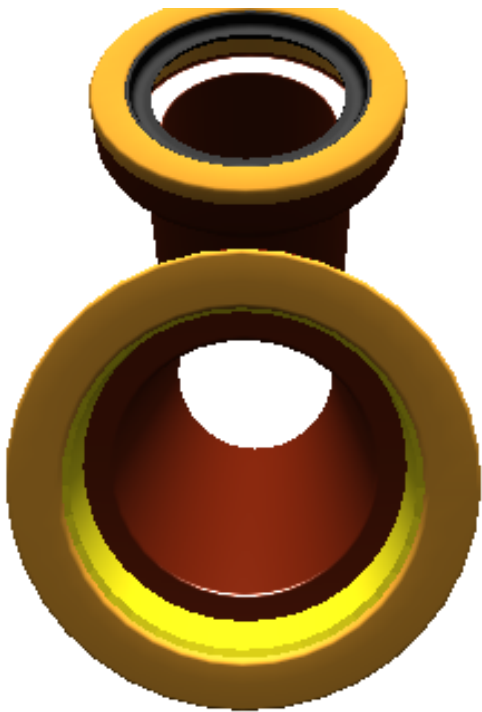

TECHNICAL DRAWING

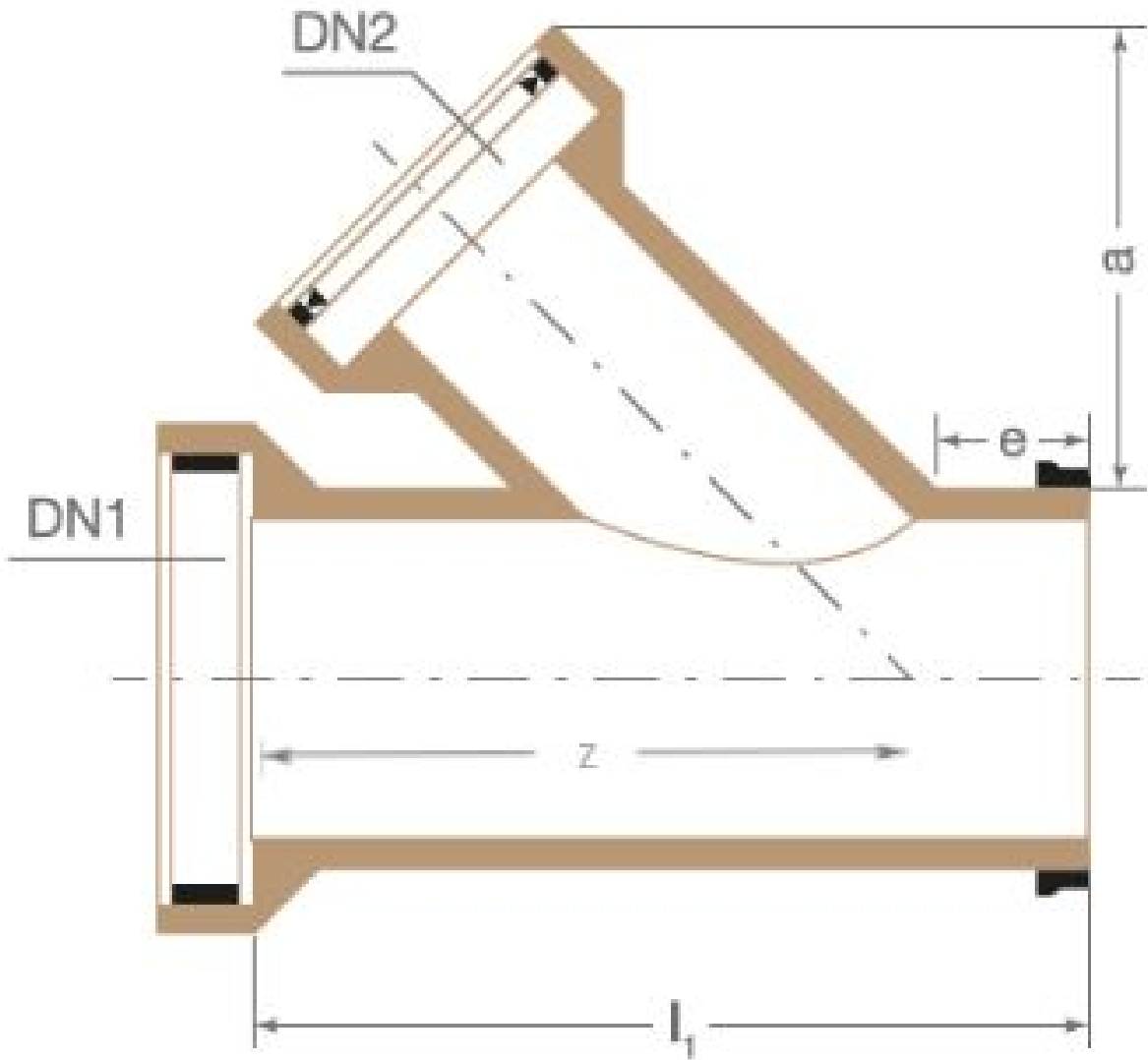

NOMINAL SIZE DN1 250

- 100
- 125
- 150
- 200
- 250
- 300

NOMINAL SIZES DN2

- 100
- 125
- 150
- 200

JOINT DN1/DN2

- KK
- LL
- KL

LENGTH (CM)

60

WEIGHT

TKL

48 kg/piece

160/200

MEASUREMENTS

Nominal size	Branch size	Dimensions		
DN 1	DN 2	z max. mm	e max. mm	a max. mm
250	200	465	85	370

BRIEF DESCRIPTION

Angle  $\pm 5^\circ$

The dimensions z, a and e are reference values. Other dimensions and crushing strengths: see pipes. The strength class of the branch piece is always normal strength.

Vitrified clay pipes and fittings are standardised in EN 295-1. Supplementary requirements defines the certification program ZP WN 295. All measurements - especially when connecting to other products - must be checked and depend on the specifications of EN 295 and on the certification program ZP WN 295. Subject to technical changes.

